

C. 3. 154
Thos. Afflick.

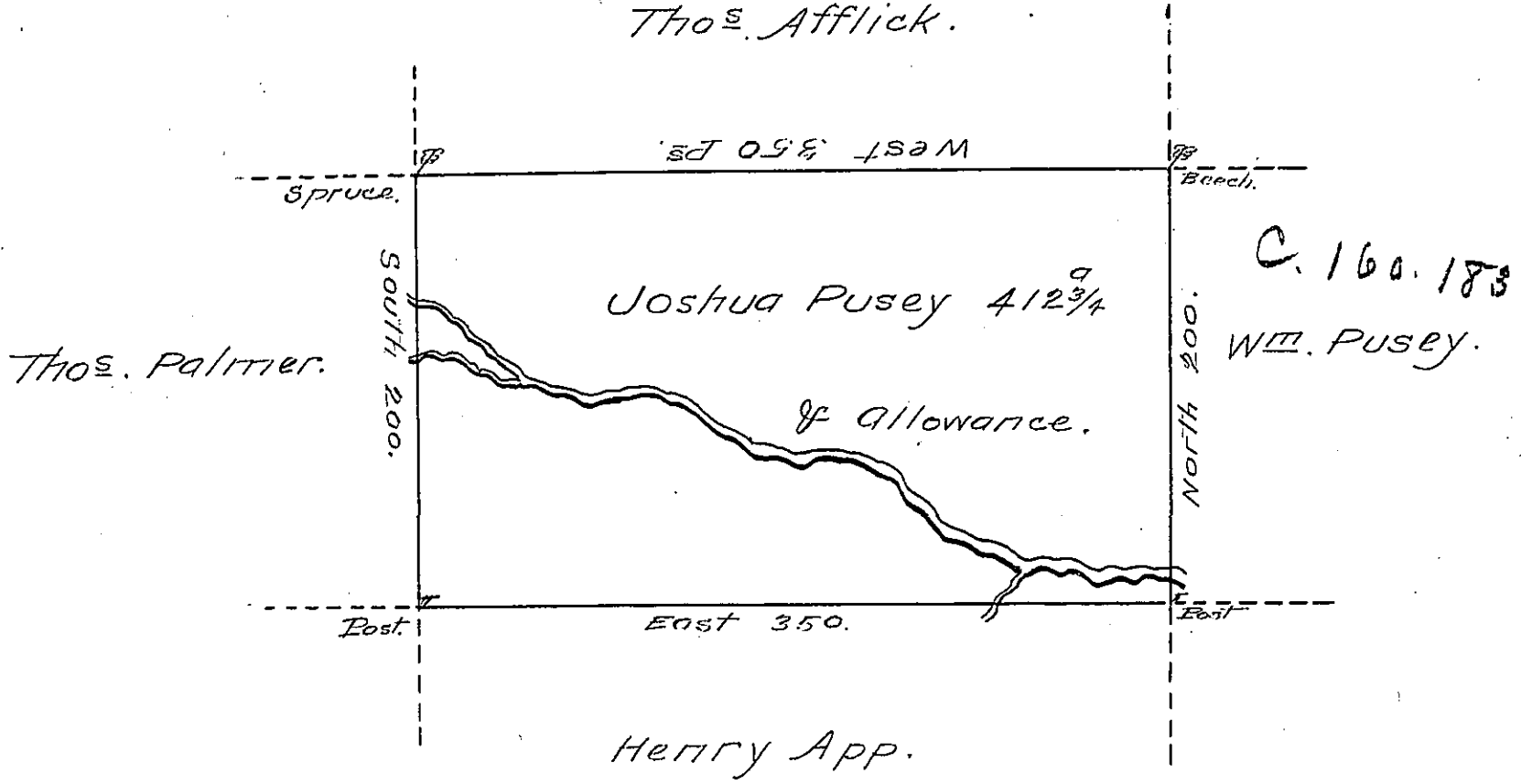

A Draught of a Tract of Land Called —
 Situate on the Waters of Snake Creek adjoining Land
 of Henry App and others in Stoke Township and
 County of Northumberland, Surveyed on the 28th —
 day of Sep^r. 1787 For Joshua Pusey, by Virtue of his
 Warrant bearing date the 27th day of July 1787 —
 Containing four Hundred and Twelve Acres & 3/4^{ths} —
 and allowance of Six & Cent for Roads &c.

To John Lukens Esq^r }
 Surveyor Gen^l. }

By Wm. Gray D.S.

IN TESTIMONY that the above is a copy of the original remaining on file in
 the Department of Internal Affairs of Pennsylvania, made
 conformably to an Act of Assembly approved the 16th day of
 February, 1833, I have hereunto set my Hand and caused
 the Seal of said Department to be affixed at Harrisburg,
 this Twenty ninth day of May 1906.

Joacn P. P...
 Secretary of Internal Affairs.